

LE Series



Laser Measurement Sensors

- Intuitive display, simple adjustment
- Precision laser measurement
- Specifications and ordering





LE Series Sensors

Two-line, eight character display



Bright LED indicators provide clear status indication for analog output, discrete output and power

Pushbutton programming for easy set up, troubleshooting and real-time distance measuring



Durable IP67-rated zinc housing stands up to extreme industrial environments

Acrylic Lens Cover

Class 1 or Class 2 laser with small, highly visible, spot for easy sensor alignment and small object detection

Remote input allows for remote teaching, laser enable and advanced measurement modes to expand the range of applications solved with a single sensor

Intuitive Display, Simple Adjustment

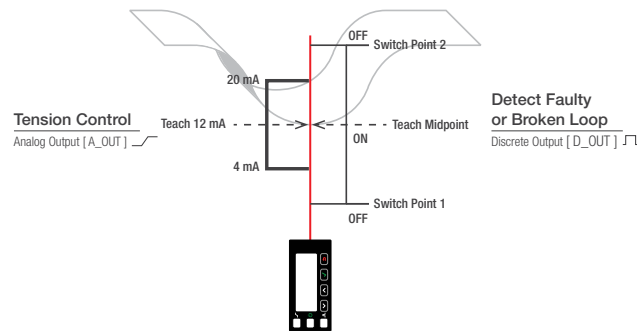
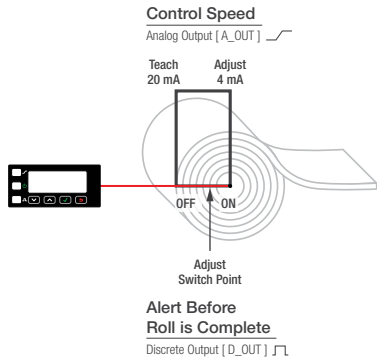

Setting Options:

2-Point Teach
Teach two targets as the end points of the analog span or discrete output window

Mid-Point Teach
Teach a window of user-defined size around a target

Push Button Adjust
Manually set analog and discrete output end points without presenting a target

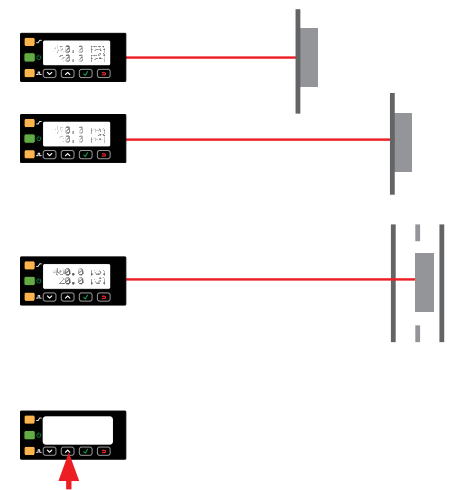

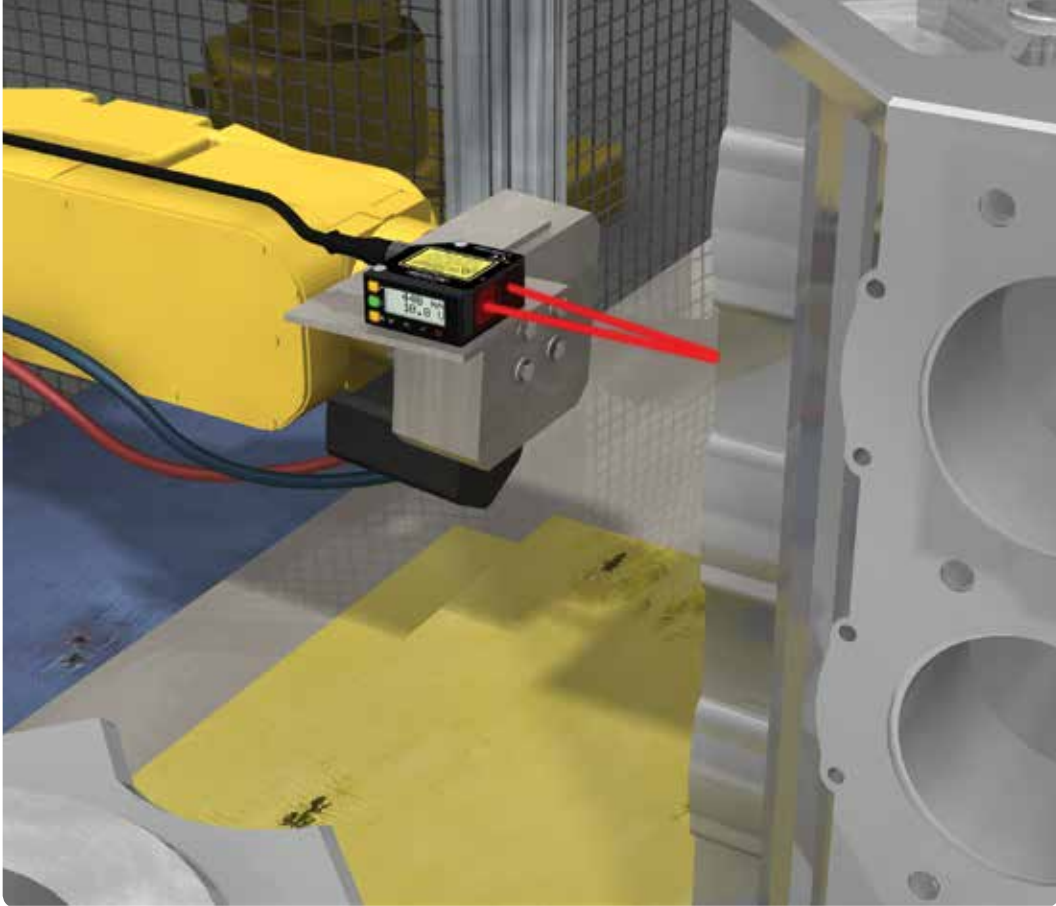

Precision Laser Measurement

LE250

- Measurement Range up to 400 millimeters
- Resolution as fine as 0.02 millimeters
- Small laser spot for detecting small features and best performance across changing colors and reflectivity

LE550

- Measurement Range up to 1 meter
- Sub millimeter resolution across entire range
- Larger spot for better measurement stability across uneven surfaces



1.2 x 0.9 mm



12.1 mm x 4.9 mm

400 mm

1000 mm



LE Series Sensors



550 = 100-1000 mm
250 = 100-400 mm

I = 4 to 20 mA analog and (1) NPN/PNP discrete
U = 0 to 10 V analog and (1) NPN/PNP discrete
D = (2) NPN/PNP discrete
K = IO-Link and (1) PNP discrete

Blank = Class 2
C1 = Class 1

Blank = 2 m Integral Cable
Q = Rotatable M12 Euro QD
QP = PVC M12 Euro Pigtail QD
W/30 = 9 m Integral Cable

QD models require mating cordset

NOTE: Discrete NPN/PNP is user configurable



Supply Voltage 12 to 30 V dc
Operating Conditions Temperature: -20° to +55° C
Humidity: 90% at +55° C
Construction Housing: Die-cast zinc
Lens Cover: Acrylic

Environmental Rating IEC IP67, NEMA 6
Certifications CE, UL LISTED

Accessories

Brackets



SMBLEL SMBLEU SMBLEFA

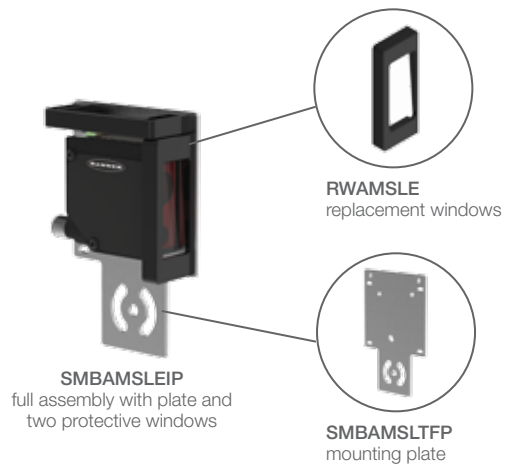

SMBAMSLEIP full assembly with plate and two protective windows

SMBAMSLTFP mounting plate

Cordsets



Type	Length	Model
5-Pin M12/Euro-Style Cordsets with Shield Straight connector models listed	2 m (6.5')	MQDEC2-506
	5 m (15')	MQDEC2-515
	9 m (30')	MQDEC2-530
	15 m (50')	MQDEC2-550

